

LED DOWN LIGHT RETROFIT

MHTL-DL Low Power Series

Project _____

Part Number _____

Quantity _____



APPLICATIONS

- Airport, Corporate Campus
- Data Center, Healthcare, Retail

FEATURES

- >50,000 Hours Rated Lifespan
- 5-year Warranty
- L70 > 50,000 Hours
- Aluminum Housing with LED Driver on Top
- Spring Clips Provide Easy Retrofit Installation
- CFL Ballast Compatible - Direct Replacement
- Designed to Fit Most Existing IC or Non-IC Housing
- Wet Location Rated
- UL Listed and Meet DLC Standards
- TAA/BAA Compliant



SPECIFICATIONS

- Input Voltage 110 - 277V
- Operation Frequency 60Hz
- Fixture Efficiency > 85%
- CRI 80 or CRI 90
- Surge Protection
- CCT 3000K/3500K/4000K/5000K
- THD < 17% @277V
- Power Factor > 0.90 @277V

Model	Input Power	CCT	Lm/W	Lumen	Dimensions
MHTL-DL-4-9W-35K-U	9W	3500K	80	720	Ø5.10" x 3.47"
MHTL-DL-6-13W-35K-U	13W	3500K	80	1040	Ø7.40" x 3.31"



Manufactured in the USA

Toll Free **888-511-7780** • www.mhtlighting.com



LED DOWN LIGHT RETROFIT

MHTL-DL Low Power Series

Project _____

Part Number _____

Quantity _____

ORDERING CODES

MHTL-DL			U		
Size and Wattage:	Color Temperature:	Input Voltage:	CRI:	Option:	
4-9W=4" 9W	3K=3000K	U=110-277V	80=CRI 80	(Standard in White Trim)	
6-13W=6" 13W	35K=3500K		90=CRI 90	DB=Triac Dimming	
	4K=4000K				
	5K=5000K				

***DLS Series is Available Upon Request (4" or 6" Square Down Light)**

DIMENSIONS

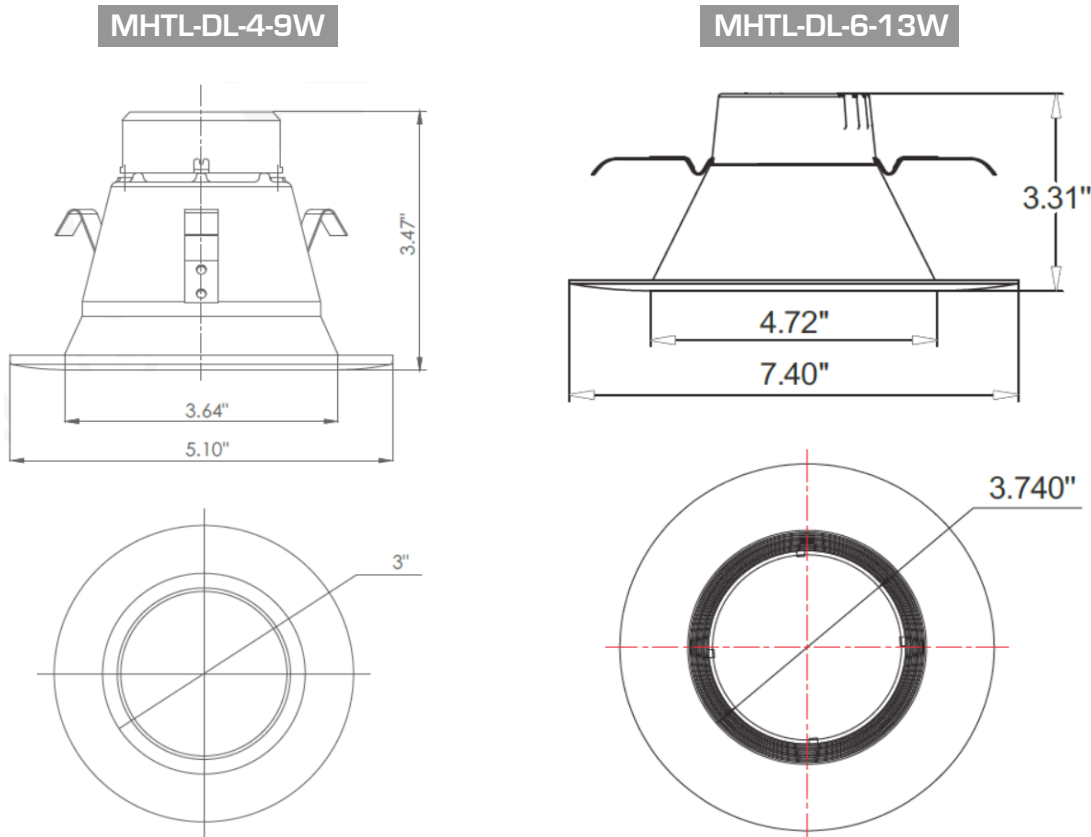

- MHT Products are UL Listed Assembled in ISO9000/1 Certified US Facility
- MHT Lighting Offers a 5-year Warranty (See Warranty Terms and Conditions)
- Every Product is Quality Tested and Inspected Prior to Shipment
- Proudly Manufactured in the USA
- For Product IES Files Please Contact Your Local Reps

MHT Plant Operations

1961 Richmond Terrace
Staten Island, New York 10302
Tel: (718) 524-4370
Fax: (718) 524-4390

West Coast Operations

2285 Michael Faraday Dr. Suite 10
San Diego, California 92154
Tel: (619) 661-0600

www.mhtlighting.com

888-511-7780

MHT Confidential
Rev Date: May 2018