

# LED FLAT PANEL

## MHTL-PAN-DIR SERIES

Project \_\_\_\_\_  
 Part Number \_\_\_\_\_  
 Quantity \_\_\_\_\_

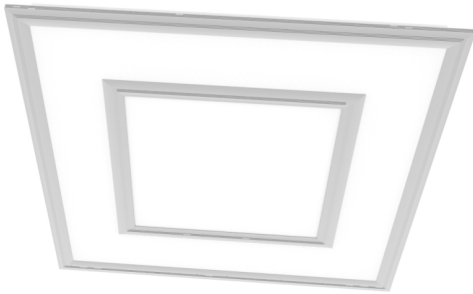

### APPLICATIONS

- Conference/Meeting Room
- Commercial Building
- Healthcare
- Office and School

### FEATURES

- 10-year Warranty
- >100,000 Hours Rated Lifespan
- L70 > 67,000 Hours
- Aluminum Extrusion Construction
- High Performance Acrylic Lens
- No Glare and Full Even Light Distribution
- 1/2" Knock-outs on Top Access Panel
- Standard Grid Mount with Cable Mount Brackets
- Optional Integrated Motion Sensor
- Optional Integrated Emergency Battery Backup
- TAA/BAA Compliant



### LED/DRIVER

- Universal Input Voltage 120 - 277V
- Optional Input Voltage 347V/480V
- Surge Protection
- 0-10V Dimmable Driver
- CRI > 85
- Color Temperature 3000K - 5000K
- THD < 10% @120V
- Power Factor > 0.98 @120V

Model	Input Power	Lumen	Dimensions
MHTL-PAN-DIR-2X2-38E-4K-U	38W	> 4,200	23.75" x 23.75" x 1.8"
MHTL-PAN-DIR-2X4-53E-4K-U	53W	> 6,000	23.75" x 47.75" x 1.8"



Manufactured in the USA

Toll Free **888-511-7780** • [www.mhtlighting.com](http://www.mhtlighting.com)



# LED FLAT PANEL

## MHTL-PAN-DIR SERIES

Project \_\_\_\_\_

Part Number \_\_\_\_\_

Quantity \_\_\_\_\_

### ORDERING CODES

MHTL-PAN-DIR					
<u>Wattage:</u>	<u>Color Temp:</u>	<u>Input Voltage:</u>	<u>Mounting:</u>	<u>Option:</u>	
2X2-38E	3K=3000K	U=120-277V	SM=Surface Mount	(Standard in Aluminum Trim)	
2X4-53E	35K=3500K	347=347V	DK=Drywall Kit	AC=Aircraft Cable	
	4K=4000K	480=480V	PM=3/8"	EB=Emergency Battery Backup	
	5K=5000K		Threaded Rod	OS-On/Off=On/Off Only Motion Sensor	
				OS-Dim=Dimming & On/Off Motion Sensor	
				(See "Integrated Control" Series for Details)	

MHTL-PAN-DIR-2X4-53E-4K-U is DLC Listed Product

### DIMENSIONS

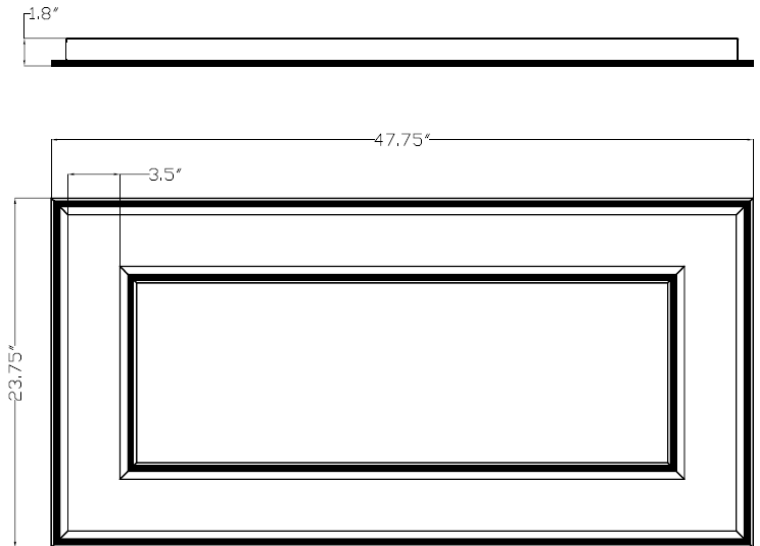
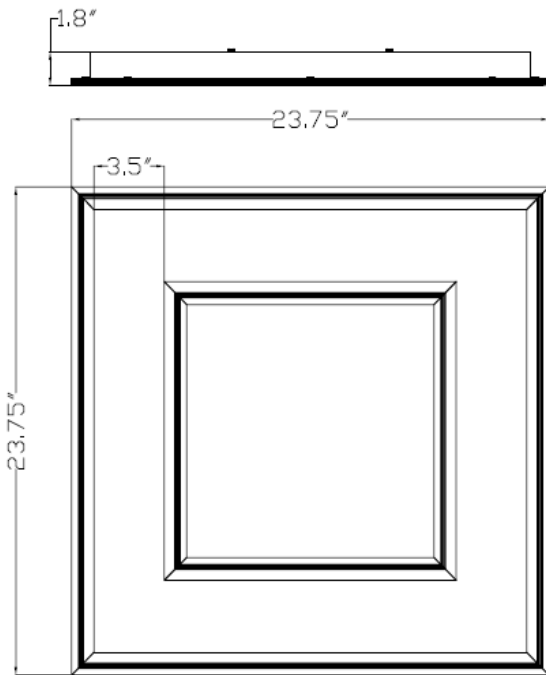

- MHT Products are ETL Listed and Assembled in ISO9000/1 Certified US Facility
- MHT Lighting Offers a 10-year Warranty (See Warranty Terms and Conditions)
- Every Product is Quality Tested and Inspected Prior to Shipment
- Proudly Manufactured in the USA
- For Product IES Files Please Contact Your Local Reps

#### MHT Plant Operations

1961 Richmond Terrace  
 Staten Island, New York 10302  
 Tel: (718) 524-4370  
 Fax: (718) 524-4390

#### West Coast Operations

2285 Michael Faraday Dr. Suite 10  
 San Diego, California 92154  
 Tel: (619) 661-0600

[www.mhtlighting.com](http://www.mhtlighting.com)

**888-511-7780**

MHT Confidential  
 Rev Date: May 2018