

mhtlighting

illuminating PoE technology

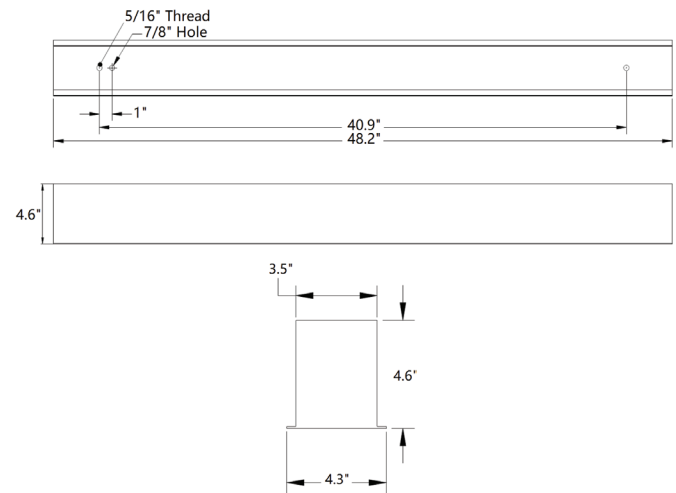

DIMENSIONS



MHTi-CUBE-G-SC



LED LINEAR RECESSED GRID Series

The inspeXtor Platform is a PoE Lighting Management System providing Building Automation and Data Collection PoE Systems are Safe and Efficient Low Voltage Platform

FEATURES

- Linear Recessed Grid LED Fixture Complete with Integrated Sensor and Driver Node

GENERAL INFORMATION

Applications	Commercial, Hospitals and Health Care, Residential, Education & Industrial
Warranty	10-Year Warranty
Construction	Matte White Extruded Aluminum Housing Designed for Recessed Grid Ceiling Installations. 5/16" Threaded Holes On Top of Fixture for Additional Cable Support Lens: White Polycarbonate - Low Glare
Certifications	  

PRODUCT DATA

Electrical	Integrated PoE Low, Voltage Driver Node, Optional Integrated Emergency, Battery Backup and Motion Sensor.
Mounting	Recessed Grid Ceiling Mount
Lumens	500 - 1,000 Lumens Per Foot
Max Input Power	7W Per Foot
CRI	> 85
CCT	3000K/3500K/4000K/5000K/Tunable (2700K to 5700K)
L70 Lifetime	> 60,000 Hours
Rated Lifespan	> 100,000 Hours
Dimensions	Standard in 4-Foot or 8-Foot Housing Lengths (Custom Lengths Available) 4FT: 48.2" x 4.3" x 4.6" 6FT: 72.2" x 4.3" x 4.6" 8FT: 96.2" x 4.3" x 4.6"

PHOTOMETRICS

MHTi-CUBE-G-SC-4FT-800-35K

Luminaire Output: 800 Lumens Per Foot

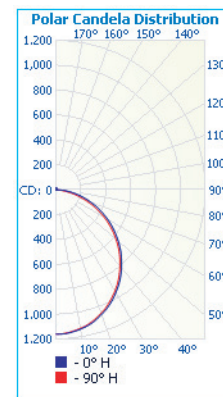

Distance	Illuminance at a Distance	
	Center Beam fc	Beam Width
1.5ft	517 fc	4.1 ft
3.0ft	129 fc	8.2 ft
4.5ft	57.5 fc	12.3 ft
6.0ft	32.3 fc	16.4 ft
7.5ft	20.7 fc	20.5 ft
9.0ft	14.4 fc	24.5 ft

■ Vert. Spread: 107.5°
■ Horiz. Spread: 108.1°

ORDERING INFO: Sample Code - MHTi-CUBE-G-SC-4FT-600-35K-EM

Series	Size	Direct Light	Color Temperatures	Options
MHTi-CUBE-G-SC				
MHTi-CUBE-G-SC	4FT - 48-inch 6FT - 72-inch 8FT - 96-inch Custom Size - _____	500 - 500 lm/ft 600 - 600 lm/ft 700 - 700 lm/ft 800 - 800 lm/ft 1000 - 1,000 lm/ft	3K - 3000K 35K - 3500K 4K - 4000K 5K - 5000K AT - 2700K to 5700K	(Blank) - Standard in White EM - Emergency Battery Backup IS - Integrated sensor